

Composite dry sliding bushings, Composite dry sliding thrust washers

Principal dimensions					Basic load ratings		Mass	Designation
d	D	H	J	K	dynamic C	static C0		
mm					kN		kg	-
20	36	1,5	28	3,25	85	176	0,0067	PCMW 203601.5 M

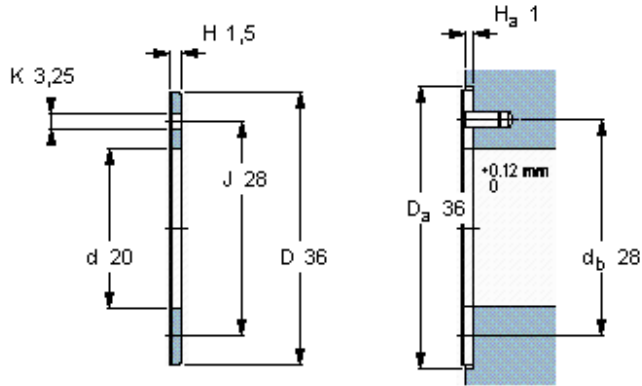

Specific load factor
Material constant

K 120
K_M 1900